

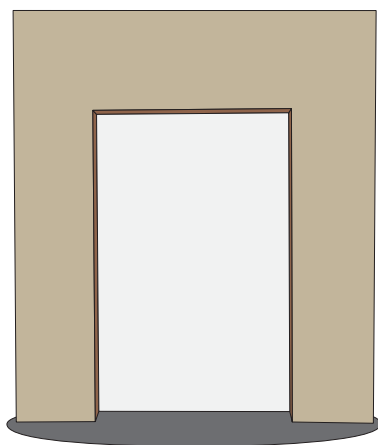

DOUBLE INSTALLATION MANUAL

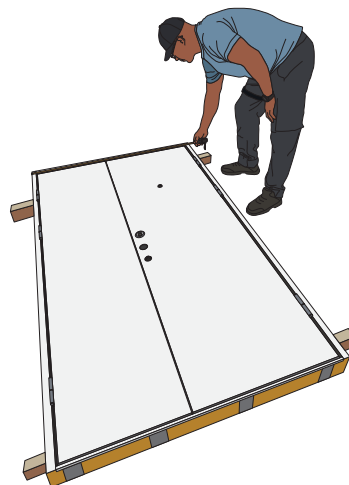

STEP 1. Check the door opening. Double door allowed to be mounted in standard rigid wall, no less than 150 mm thickness and density 650 kg m³.



STEP 2. The door frame must be fit in the wall opening to make its external plane align with the wall plane as best as possible. The gaps tolerance between the wall and the jamb are 5-20 mm.

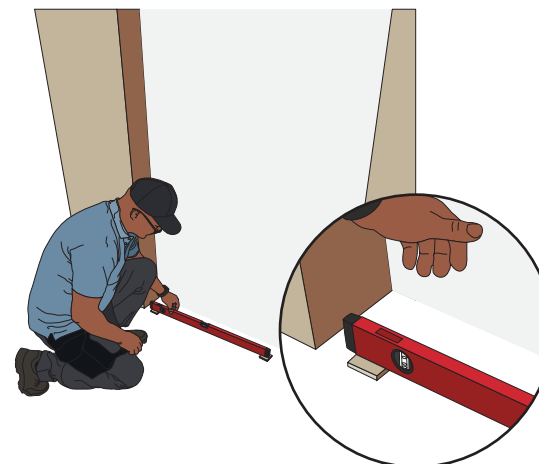
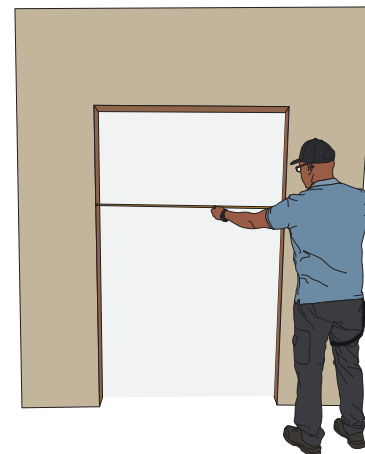

STEP 3. The pad is inserted under the door frame on the side of the hinges (5-10 mm in thickness). The pad is necessary for getting some looseness under the door frame on the side of the locks, which is needed to even the side of the door frame pins.

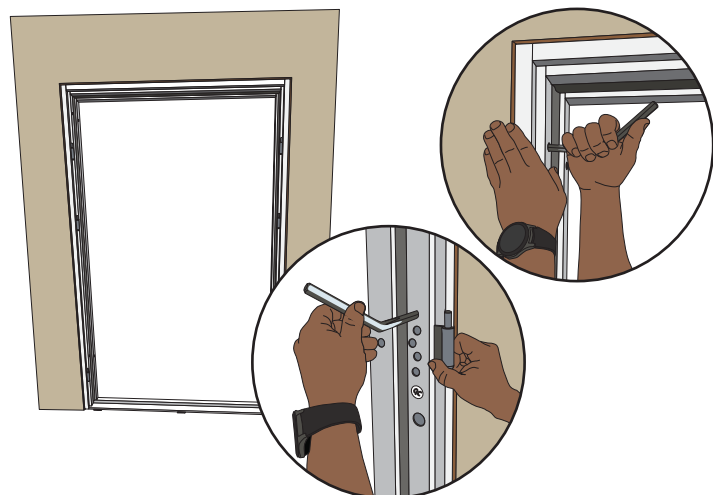

STEP 4. Double door frame is set into the wall opening, that outside plane even with the plane of the wall as much as possible. The double door frame is anchored into the opening by the adjustable bolts.

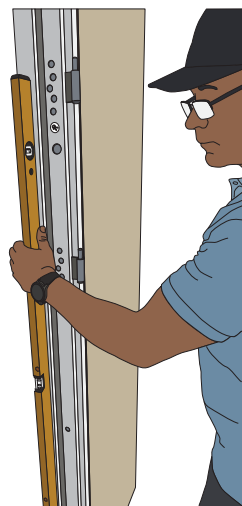

STEP 5. The level is used to even the hinge side (the allowed tolerance between the upper and the lower corner of the door frame is 2 mm).



STEP 6. Drill the wall at the adjustable bolt or installation bolt points in the vertical part of the door frame (on both sides at the upper part of the frame). For rigid wall — concrete screw Ø7,5 mm L-112 mm;

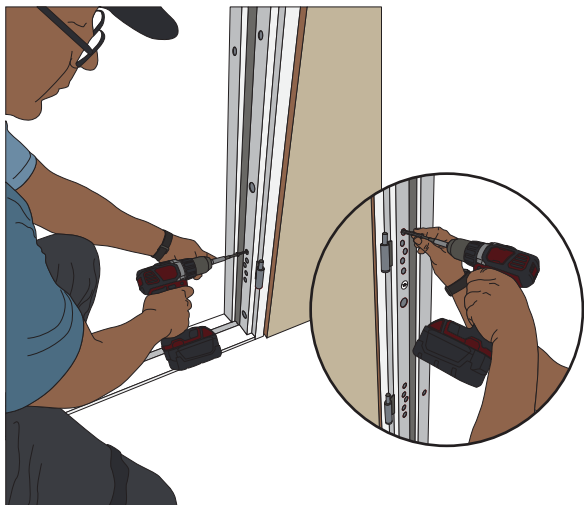

STEP 7. Fix the double door lower frame on both hinge sides to the wall using remainings bolts.

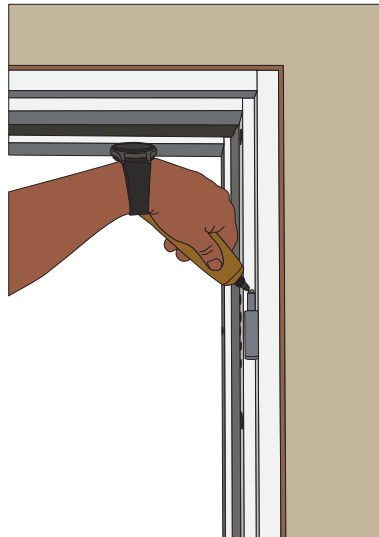

STEP 8. Hinges are lubricated.

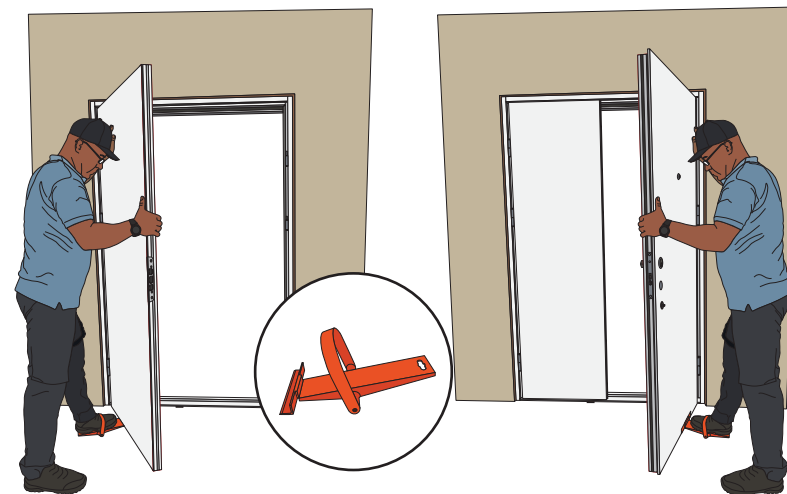

STEP 9. Both door leafs is hanged on the hinges using lever. Then align the door frame so that both door leafs and the frame are in the same plane.

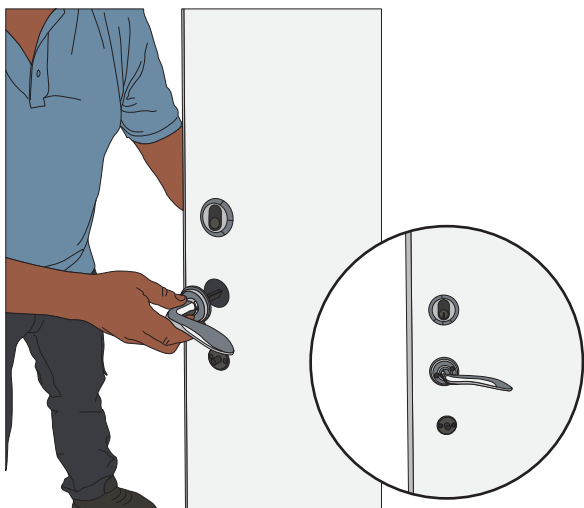

STEP 10. Handle, cylinder* and/or spinner are installed into the door leaf, the protection of the cylinder is affixed.

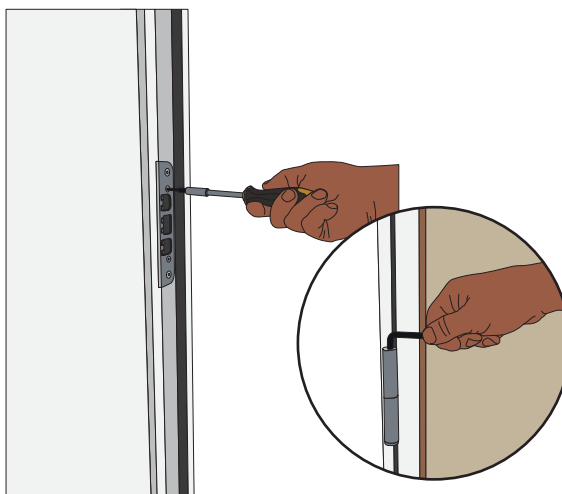

STEP 11. If needed make adjustemnt of the stricking plate and hinges on both sides.



STEP 12. The gaps between the wall and the jamb are sealed with the fire resistant polyurethane foam "Penosil Premium Fire Rated B1" or with the fire resistant mineral wool class A1 or A2-s1, d0.